

AIR CLEANER SERVICE INSTRUCTIONS

1. DO NOT attempt to repair or adjust any electrical or mechanical functions on this unit. Doing so will void the warranty. The inside of the unit contains no user serviceable parts. All servicing should be performed by qualified personnel only.
2. If you need to exchange the unit, please return it in its original carton, with a sales receipt, to the store where you purchased it. If you are returning the unit more than 30 days after the date of purchase, please see the enclosed warranty.
3. Should your air cleaner require service, please call **1-800-253-2764** in North America for further assistance. A return authorization will be given when you call.
4. If you have any other questions or comments, feel free to write to us:

Bionaire
JCS/THG, LLC
Consumer Service Department
303 Nelson Avenue
Neosho, MO 64850

Visit our website at www.bionaire.com.

FIVE (5) YEARS LIMITED WARRANTY**SAVE THIS WARRANTY INFORMATION**

- A. This Warranty applies only to the original purchaser of this product.
- B. This Warranty applies ONLY to repair or replacement of any supplied or manufactured parts of this product that, upon inspection by JCS/THG, LLC authorized personnel, is shown to have failed in normal use due to defects in material or workmanship. JCS/THG, LLC will determine whether to repair or replace the unit. This Warranty does not apply to installation expenses.
- C. Operating this unit under conditions other than those recommended or at voltages other than the voltage indicated on the unit, or attempting to service or modify the unit, will render this WARRANTY VOID.
- D. Unless otherwise proscribed by law, JCS/THG, LLC shall not be liable for any personal injury, property or any incidental or consequential damage of any kind resulting from malfunctions, defects, misuse, improper installation or alteration of this product.
- E. All parts of this product excluding filters, which are covered under separate warranty, are guaranteed for a period of 5 years as follows:
 1. Within the first 30 days from date of purchase, the store from which you purchased your product should replace this product if it is defective in material or workmanship (provided the store has in-stock replacement.) If you intend to assert any claim in connection with the product, please follow the instructions in paragraph F.
 2. Within the first 60 months from date of purchase, JCS/THG, LLC will repair or replace the product if it is defective in material or workmanship, subject to the conditions in paragraph G.
- F. If you have any other problem or claim in connection with this product, please write to our Consumer Service Department.
- G. IMPORTANT RETURN INSTRUCTIONS. Your Warranty depends on your following these instructions if you are returning the unit to JCS/THG, LLC:
 1. Carefully pack the item in its original carton or other suitable box to avoid damage in shipping.
 2. Before packing your unit for return, be sure to enclose:
 - a) Your name, full address with zip code and telephone number
 - b) A dated sales receipt or PROOF OF PURCHASE,
 - c) Your \$7.50 check for return shipping and handling, and

- d) The model number of the unit and the problem you are having. (Enclose in an envelope and tape directly to the unit before the box is sealed.)
3. JCS/THG, LLC recommends you ship the package U.P.S. ground service for tracking purposes.
4. All shipping charges must be prepaid by you.
5. Mark the outside of your package:

Bionaire
JCS/THG, LLC
303 Nelson Avenue
Neosho, MO 64850

SHIPPING AND HANDLING CHARGES: \$7.50 (USD)

This Warranty gives you specific legal rights, and you may have other rights which vary from state to state. The provisions of this Warranty are in addition to, and not a modification of, or subtraction from, the statutory warranties and other rights and remedies contained in any applicable legislation. To the extent that any provision of this Warranty is inconsistent with any applicable law, such provision shall be deemed voided or amended, as necessary, to comply with such law.

© 2006 JCS/THG, LLC

Bionaire®, the Bionaire logo® and PERMAtech® are trademarks of JCS/THG, LLC.

BAP141206EM1

Printed in China

BIONAIRE
PERMAtech®
air cleaner
MODEL BAP1412



Read instructions
before operating.
Retain for future reference.

Instruction Leaflet

INFO-LINE

If after having read this leaflet, you have any questions or comments on your air cleaner, call **1-800-253-2764** in North America.

9100040002641

AIR CLEANER SAFETY

PLEASE READ AND SAVE THESE IMPORTANT SAFETY INSTRUCTIONS

IMPORTANT SAFEGUARDS

When using electrical appliances, basic safety precautions should always be followed to reduce the risk of fire, electric shock, and injury to persons, including the following:

- Read all instructions before using the appliance.
- To avoid fire or shock hazard, plug the appliance directly into a 120V AC electrical outlet.
- If the filter is covered by a bag when shipped: Remove plastic bag before use.
- Keep the cord out of heavy traffic areas. To avoid fire hazard, NEVER put the cord under rugs, near heat registers, radiators, stoves, or heaters.
- To protect against electrical hazards, DO NOT immerse in water or other liquids. Do not use near water.
- Close supervision is necessary when any appliance is used by or near children, or disabled persons.
- Always unplug the air cleaner before moving it, opening the grill, changing the filters, cleaning, or whenever the air cleaner is not in use. Be sure to pull by the plug and not the cord.
- NEVER drop or insert any object into any openings.
- DO NOT operate any appliance with a damaged cord or plug, if motor fan fails to rotate, after the appliance malfunctions, or if it has been dropped or damaged in any manner. Return appliance to manufacturer for examination, electrical or mechanical adjustment, or repair.
- Use appliance only for intended household use as described in this manual. Any other use not recommended by the manufacturer may cause fire, electric shock, or injury to persons. The use of attachments not recommended or sold by JCS/THG, LLC may cause hazards.
- DO NOT use outdoors.
- NEVER block the air openings, grills/outlets or place on a soft surface such as a bed or sofa, as this could cause the unit to tip over, blocking the air intake opening/grill.
- Keep unit away from heated surfaces and open flames.
- DO NOT attempt to repair or adjust any electrical or mechanical functions on this unit. Doing so will void your warranty. The inside of the unit contains no user serviceable parts except the filter. All servicing should be performed by qualified personnel only.

- **WARNING:** To reduce the risk of fire or electric shock, DO NOT use this air cleaner with any solid-state speed control device.
- DO NOT place anything on top of unit.

PLEASE READ AND SAVE THESE IMPORTANT SAFETY INSTRUCTIONS

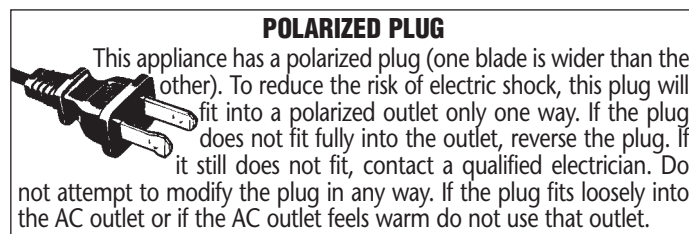

CORD AND PLUG INSTALLATION SAFETY INSTRUCTIONS

The length of cord used on this appliance was selected to reduce the hazards of becoming tangled in, or tripping over a longer cord. If a longer cord is necessary, an approved extension cord may be used. The electrical rating of the extension cord must be equal to or greater than the rating of the air cleaner. Care must be taken to arrange the extension cord so that it will not drape over the countertop or tabletop where it can be pulled on by children or accidentally tripped over.

Thank you for choosing a Bionaire® air cleaner. To ensure the best performance from your air cleaner, please read and save the following instructions.

IONIZER

Your air cleaner has an optional ionizer feature, which, when turned on, releases negative ions into outgoing filtered air. Ions are tiny particles that carry a positive or negative charge. These ions exist naturally around us, in the air, water, and ground. Both positive and negative ions are colorless, odorless, and completely harmless. Negative ions help the air purification process by attaching themselves to very small airborne particles in the room.

These particles take on a negative charge and may join with positively charged particles such as dust, pollen, smoke, and pet dander to form larger particles that are then more readily captured by the filter system, or may be attracted to positively charged surfaces throughout the home, like walls or floors. This may occur more frequently when the filter is nearing the end of its functional life expectancy and is able to capture less of the charged particles.

You may also note after extended use, that dust has collected around the grills or front panel. This is from the ionization affect caused by the negative ions exiting from the air outlet. This is additional evidence of the air cleaning effectiveness of negative ions. The dust can be easily removed with a clean, damp cloth or soft brush.

Finally, using your ionizer may result in an occasional popping or cracking sound. This is a normal sound, generally caused by a small build-up of ions that, when discharged, cause the popping or cracking sound.

NOTE: It is important to clean the PERMAtech® filter at the recommended intervals.

Using the ionizer in conjunction with dirty filters may result in dirty particles exiting the air purifier and being attracted to walls, carpets, furniture, or other household objects. These dirty particles may prove very difficult to remove. Homes with excessive amounts of pet dander, dust, or smoke may decrease the life expectancy of the PERMAtech® filtration system and may interfere with the ionization process. You may want to run the ionizer less often and check the condition of the PERMAtech® filter(s) more frequently in order to reduce particles from being attracted to surfaces throughout your home as mentioned above.

If the filters are enclosed in plastic bags please ensure that the bags are removed prior to operation.

OPERATING INSTRUCTIONS

1. Carefully unpack your air cleaner. Select a firm level place where there are no obstructions to the air inlet or filtered air outlet. A good location in a room is approximately **1 foot away** from the wall, in a central location of your home.
DO NOT POINT AIR OUTLET TOWARDS WALL.

2. Plug into a 120V AC electrical outlet.
3. Select the desired operating speed. Your air cleaner has three speed settings. You can select from HIGH (⚡), MEDIUM (⚡) or LOW (⚡) by moving the speed control to the desired setting.
4. To release negative ions into the filtered air, turn to ionizer control (⚡) to ON and the light will illuminate.
5. For optimum air filtration, it is recommended to operate the air cleaner continuously. Its rugged motor has been designed to give many years of use.

For continuous use, it's recommended to operate the air cleaner at the MEDIUM setting. For quieter operation or use in a bedroom, select the LOW setting. When high levels of air particulates are present, select the HIGH setting to quickly circulate and filter the room air.

CLEANING/MAINTENANCE INSTRUCTIONS

Turn off and unplug the unit before cleaning.

1. The outside of the air cleaner can be cleaned with a soft, damp cloth.
2. The rear air inlet grill can be removed and washed in warm soapy water (not dishwasher safe). Dry before replacing in the unit.
3. The front air outlet grill can be cleaned of dust with a small soft brush or cloth.

WARNING: Do not allow moisture to come in contact with the main housing of the air cleaner.

PERMAtech® FILTER CLEANING INSTRUCTIONS

1. Every few weeks, check the condition of the filter.
2. Turn off and unplug unit. Remove the air inlet grill by pulling the air inlet grill towards you by grasping the finger tab on the top of the unit.
3. Remove and examine the foam pre-filter. If it has collected a noticeable amount of dust or lint, remove it from the inlet of the grill and wash it in warm soapy water. Rinse and drip dry the pre-filter thoroughly before replacing it into the inlet of the grill.
4. With the rear grill removed, check the condition of your PERMAtech® filter. If the filter is dirty, remove it by gripping on both sides and pulling forward.
5. To clean the PERMAtech® filter use a brush attachment with your vacuum cleaner. Run the attachment along the inlet and outlet side of the filter trying to clean between the pleated filter layers. (Fig. 1)

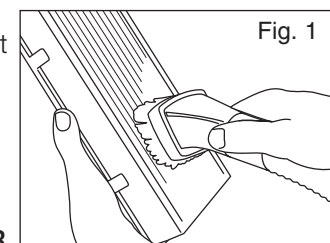

DO NOT USE WATER OR ANY OTHER HOUSEHOLD CLEANERS OR DETERGENTS TO CLEAN THE PERMAtech® FILTER.

NOTE: Vacuuming will restore performance of the PERMAtech® filter however, the filter may appear stained. This is normal and does not affect performance in any way.

6. This model utilizes a hang tab and filter clips to insure that the filter is properly in place. Before replacing the PERMAtech® filter make sure that the hang tab is securely in place. The clip can only be attached to the tabs on the filter one way. The filter clip should easily slide onto the filter hang tab with only a small amount of pressure. DO NOT use force while attaching the clip to the filter. (Fig. 2)

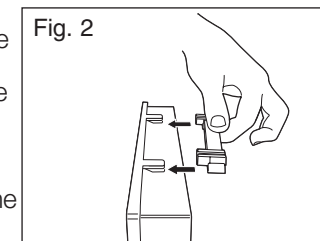

7. Align the clip on the top of the PERMAtech® filter with the rails on the inside of the cleaner unit. Gently slide the filter onto the rail (Fig. 3). **NOTE:** The side with the soft gasket should face inward.
8. Replace air inlet grill back onto unit securely.

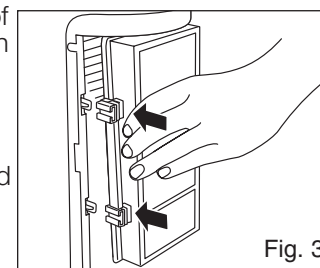

Filter Life – The filter has been designed to never need replacement, however, it does need servicing. We recommend that under normal conditions of continuous use, the filter should be cleaned at least every 3 months to help maintain optimal performance.

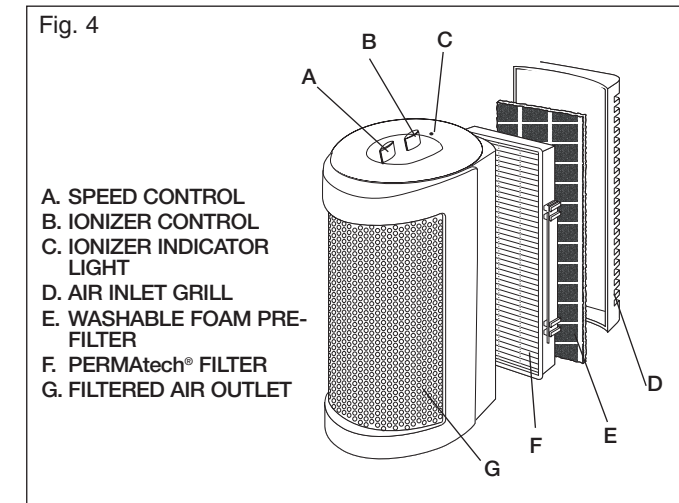

Air Cleaner Model #	Filter Quantity Needed	Filter #	Filter Description
BAP1412-U	1	323-069	PERMAtech™ Filter

Should the filter become damaged during cleaning replacements are available by calling **1-800-253-2764**.

TROUBLESHOOTING

Problem	Solution
Unit will not operate	<ul style="list-style-type: none"> • Check to make sure the unit is plugged in. • Check to make sure the unit is on by turning the speed control.
Decreased airflow	<ul style="list-style-type: none"> • Check if the PERMAtech® filter should be cleaned. • Check the filter to make sure it is in good condition. • Check to ensure nothing is blocking air inlet and filtered air outlet.. • Make sure filter bag is removed if present.
Noise	